

# TSPROF

# *PIONEER*

MANUAL

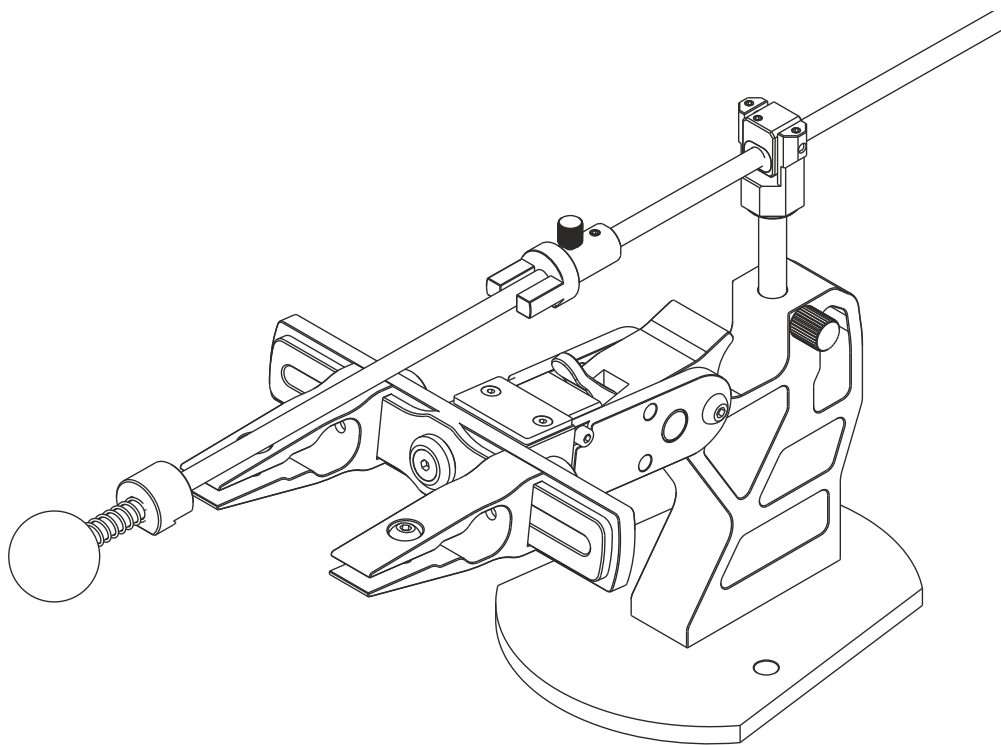

## ATTENTION!

Read this User Manual carefully before using the device. Improper use of the device may result in injury or damage to the device

The manufacturer is not responsible for damage caused by improper use of the device.

## 1. PURPOSE

The TSPROF Pioneer sharpening device (hereinafter referred to as the Device) is a universal sharpening device designed for the double-sided sharpening of knives without removing the blade from the clamps for sharpening the back side of the blade.

The device is designed for use in household conditions with an ambient temperature of 5 to 35 ° C.

## 2. SPECIFICATIONS

| SPECIFICATION                 | VALUE        |
|-------------------------------|--------------|
| Knife spine thickness         | up to 5 mm   |
| Knife blade length            | up to 250 mm |
| Knife blade width             | up to 40 mm  |
| Minimum sharpening angle      | 12°*         |
| Maximum sharpening angle      | 26°*         |
| Compatible abrasive length    | 10 – 160 mm  |
| Compatible abrasive thickness | 3 – 15 mm    |
| Weight                        | 1 200 gr     |

\*when the knife protrudes 17 mm from the edge of the clamps, with an abrasive thickness of 4 mm and a blade spine thickness of 2.4 mm. Depending on the knife and abrasive parameters, the angles may vary.

## 3. SAFETY REQUIREMENTS

- ◆ Be sure to read this User Manual before using the unit. The device should not be used by any person who is not familiar with this manual.
- ◆ This device is not intended for use by people (including children) with impaired physical, sensory, or mental capabilities, or lack of experience and knowledge unless they are supervised or instructed by a person responsible for their safety.
- ◆ Minors must be supervised to ensure that they do not play with the Device.
- ◆ Before you start working with the Device, prepare your workplace. There should be no foreign objects in the workplace of the Device. The workplace must be illuminated.
- ◆ To prevent cuts, do not touch the cutting edge of the blade with your hands. It is recommended that you wear cut-resistant gloves when using the machine..
- ◆ Do not leave unattended the device ready for operation or an open, uncovered knife blade in the reach of children and animals.

## 4. LIST OF PARTS

- A** – Body - 1 pc.
- B** – Base - 1 pc.
- C1** – Clamping arm - 1 pc.
- C2** – Arm washer - 1 pc.
- C3** – M5x16 screw - 1 pc.
- D1** – TSPROF Pioneer clamp - 2 pcs.
- D2** – TSPROF Pioneer clamp washer - 2 pcs.
- D3** – TSPROF Pioneer clamp screw - 2 pcs.
- E** – Glide hinge unit - 1 pc
- F1** – Abrasive holder - 1 pc.
- F2** – Abrasive holder guide rod - 1 pc.
- G1** – Limiter 6 mm - 1 pc.
- G2** – Limiter damper - 1 pc.
- H** – Anti-slip pad 29.5x11 - 4 pcs.
- J1** – G-clamp - 1 pc.
- J2** – G-clamp felt pad - 2 pcs.
- K** – M5x12 screw - 2 pcs.
- L** – M4x10 screw - 3 pcs.
- M1** – 1.5 mm hex key - 1 pc.
- M2** – 2.0 mm hex key - 1 pc.
- M3** – 3.0 mm hex key - 1 pc.

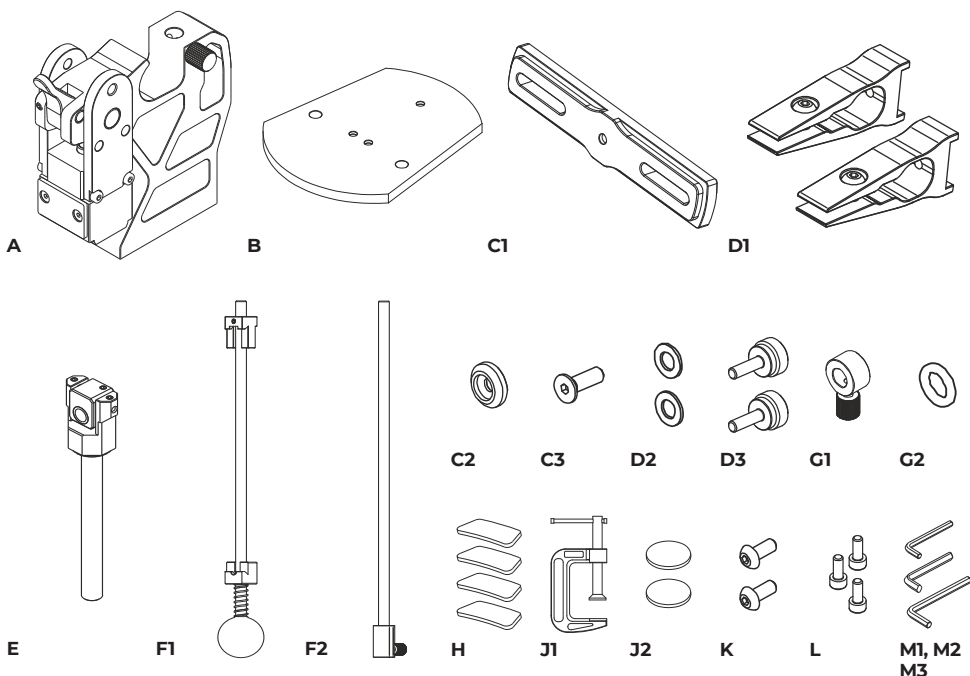
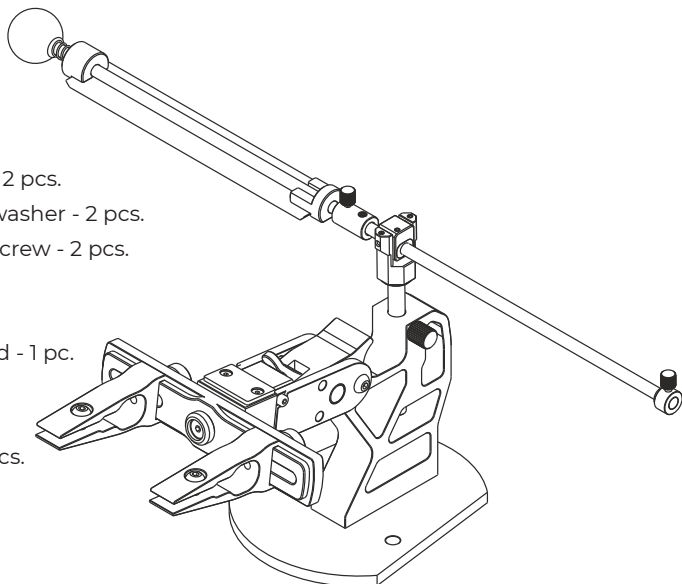

## 5. ASSEMBLY

5.1

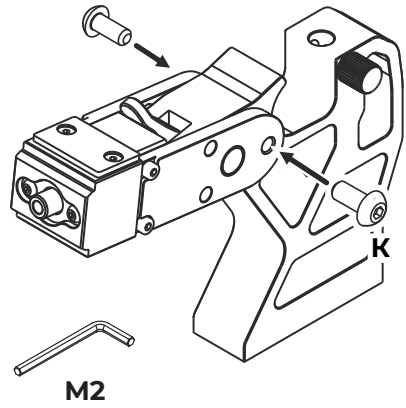
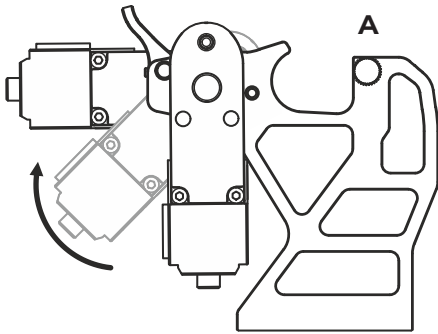

5.2

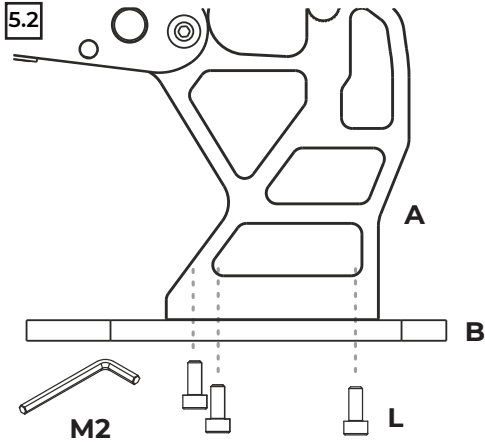

5.3

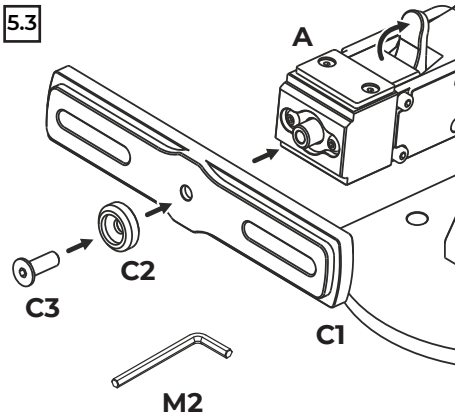

5.4

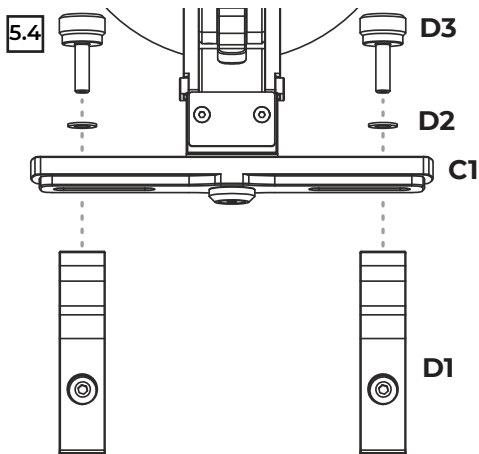

5.5

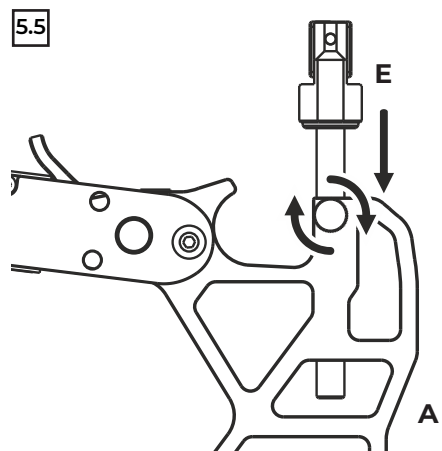

5.6

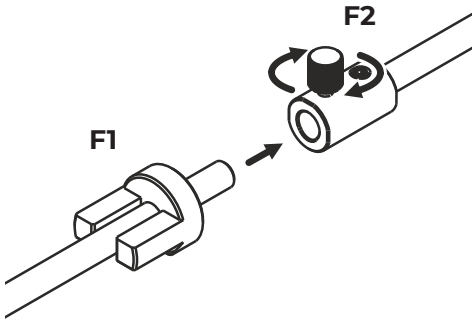

5.7

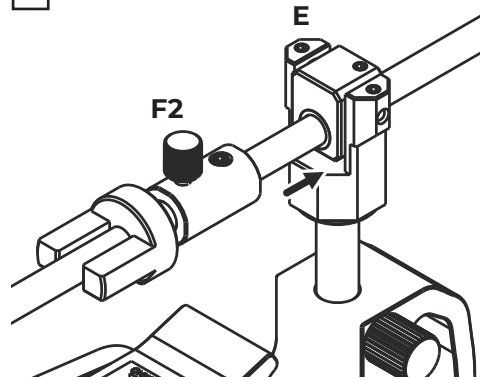

5.8

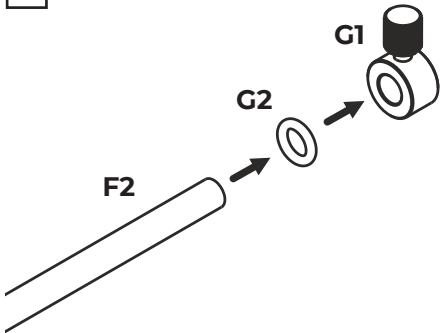

5.9

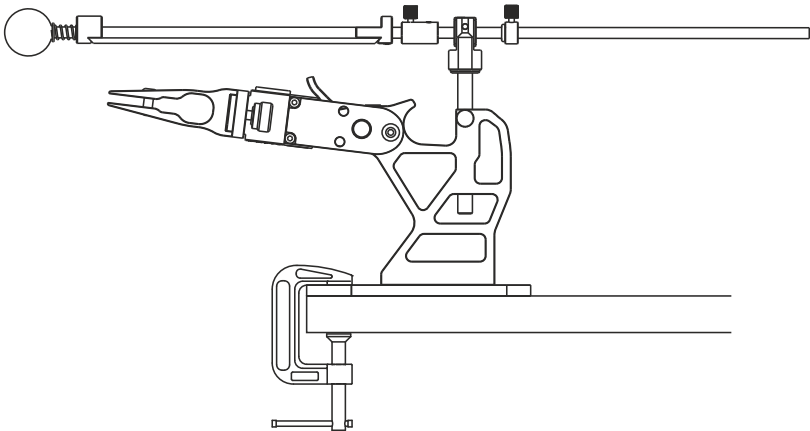
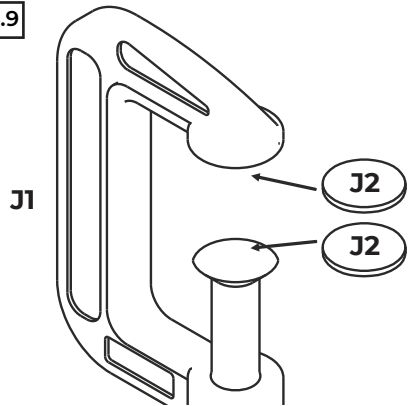

## ATTENTION!

Remember that sharpening requires extra care!  
Careless handling of the knife can result in serious injury!

## 6. HOW TO USE

- 6.1** Place the clamps according to the size of the knife.

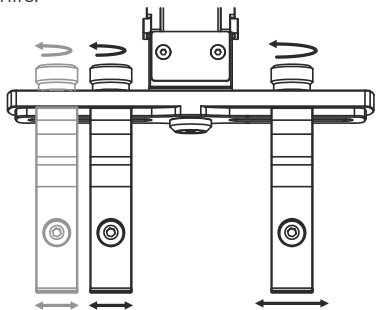

- 6.2** The clamps must fit tightly against the knife.

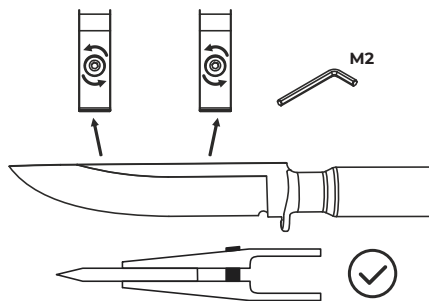

- 6.3** The cutting edge of the knife should be parallel to the clamping arm.\*

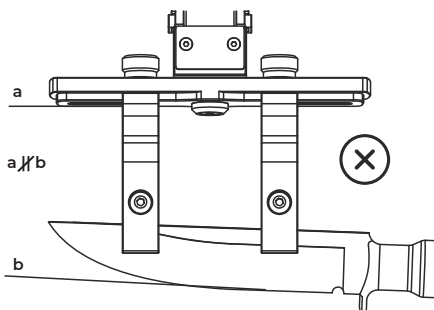
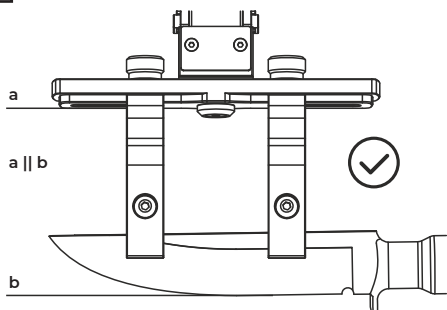

- 6.4** Standard abrasives mounted on a blank:

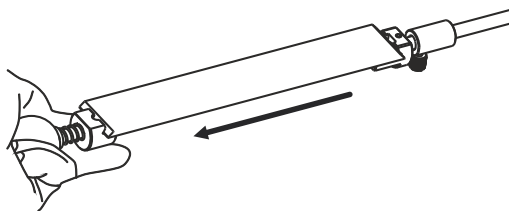

Other abrasives:

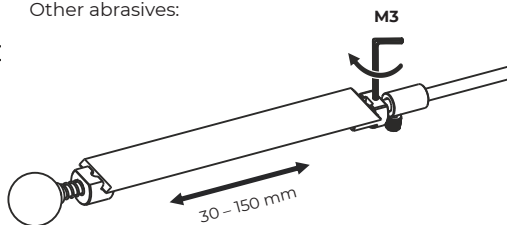

- 6.5** Set the angle depending on the knife.

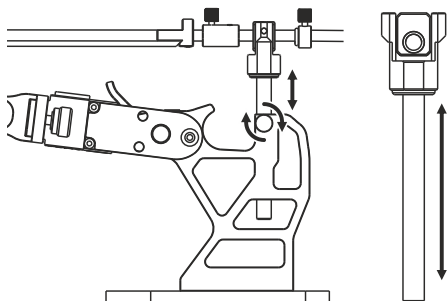

How to  
choose  
abrasives?



- F150 - coarse roughing
- F220 - cutting edge profiling
- F400 - main sharpening
- F600 - pre-finishing
- F1000 - finishing

**6.6** Adjust the stroke limiter to prevent the abrasive from leaving the sharpening area

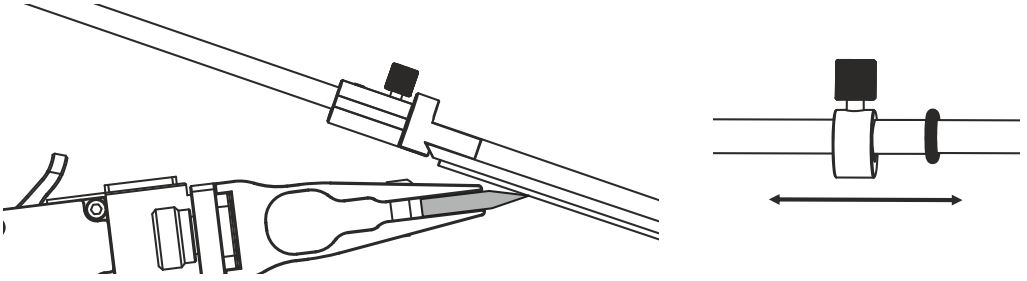

**6.7** Using an electronic angle finder.

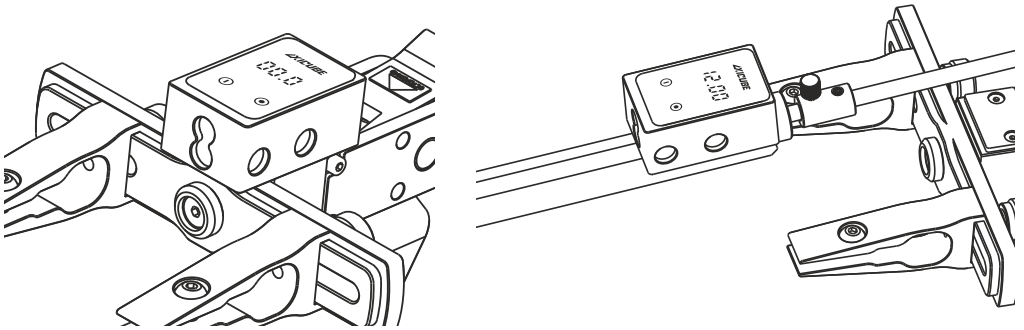

**6.8** Flip the knife, after sharpening one side.

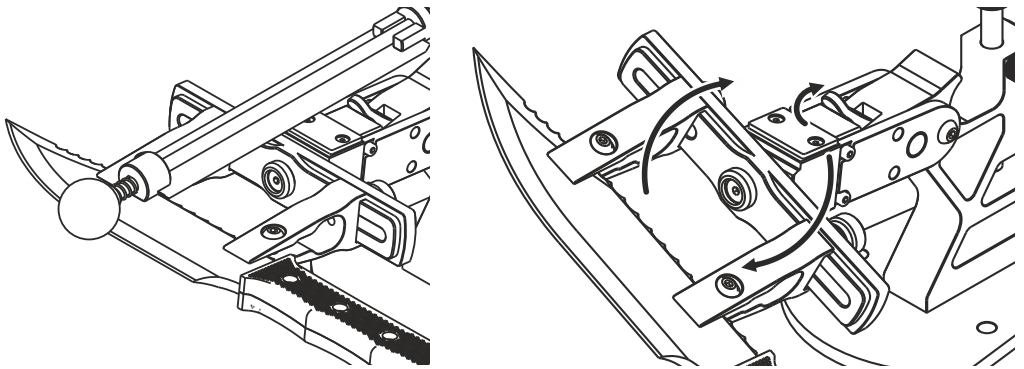

 \*More about sharpening



**BE CAREFUL**  
WHEN FLIPPING THE KNIFE

# KNIFE SHARPENING

Each knife, steel, and abrasive has its own characteristics. The general sharpening principles are described below and may be adjusted depending on the specific features of the knife.

Sharpening is performed with reciprocating movements, with an amplitude of abrasive movement along the cutting edge of 30–80 mm. The abrasive moves along both sides of the cutting edge until symmetrical bevels are formed on each side of the blade. Transition to the next abrasive stone is carried out after a burr has formed along the entire length of the cutting edge on each side of the blade.

Select a sharpening angle suitable for your knife. The table below will help you with this:

## Recommended sharpening angle, (degrees°)

|                            | 13<br> <br>15 | 16<br> <br>20 | 21<br> <br>22 | 23<br> <br>25 | 26<br> <br>29 | 30<br> <br>34 | 35<br> <br>40 | 41<br> <br>45 | 46<br> <br>50 | 51<br> <br>55 | 56<br> <br>60 |
|----------------------------|---------------|---------------|---------------|---------------|---------------|---------------|---------------|---------------|---------------|---------------|---------------|
| <b>Fillet knife</b>        |               |               |               |               |               |               |               |               |               |               |               |
| <b>Chef knife</b>          |               |               |               |               |               |               |               |               |               |               |               |
| <b>Cleaver</b>             |               |               |               |               |               |               |               |               |               |               |               |
| <b>Hunting knife</b>       |               |               |               |               |               |               |               |               |               |               |               |
| <b>Folding knife (EDC)</b> |               |               |               |               |               |               |               |               |               |               |               |

*\*the values represent the total sharpening angle*

You can also sharpen the knife at its existing sharpening angle. To do this:

- color the bevel of the knife with a marker;
- make a pass with the abrasive over the colored area;
- adjust the sharpening angle so that, as the abrasive moves, the marker is completely removed from the colored area.

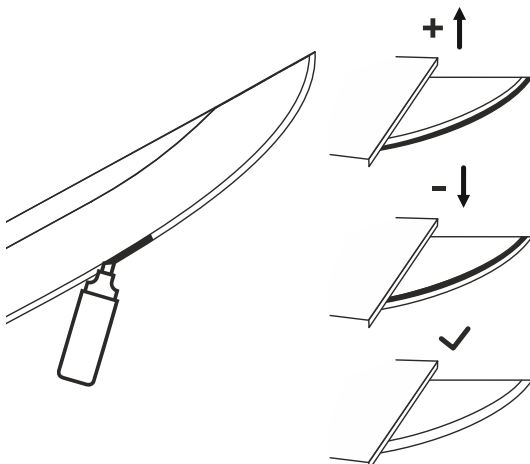

# ATTENTION!

Knife sharpening does not require pressure, regardless of the stage. Avoid applying excessive force with the abrasive against the cutting edge of the knife. Proper sharpening is achieved under the natural weight of the abrasive and the abrasive holder.

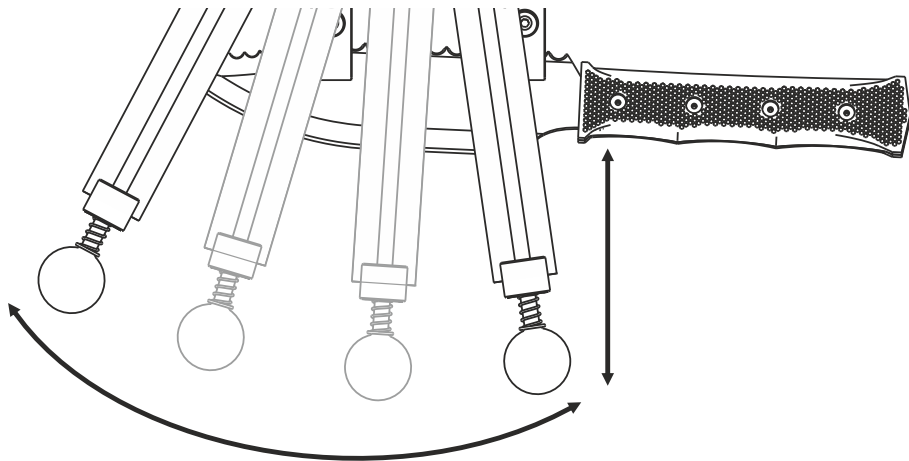

At each stage, abrasives of different grit are used, from coarse (F120) to fine (F1000 and above). Select the abrasive depending on the condition of the knife, the sharpening task, and the desired result.

- After completing each stage on one side of the knife, move the abrasive holder aside and place it in the parking position.
- Visually control the symmetry of the bevel width on both sides.
- Hold the center of the arm press the swivel mechanism lever, and rotate the arm with the clamped knife by 180°.
- Continue sharpening the opposite side of the knife

# ATTENTION!

Be careful when rotating the knife. Remember that any knife is a potentially dangerous tool. Stay focused throughout the entire sharpening session. Pay attention to hand position and the direction of the knife tip.

## 7. STORAGE AND TRANSPORTATION

Store the device in its original packaging or in a dust-free place at a temperature from +1 to +40°C. It is allowed to transport the device by all means of transport at the temperature from - 40°C to +50°C. If the device is transported at subzero temperatures, use it only after keeping it at room temperature for at least 3 hours.

## 8. DISPOSAL

Dispose of the device and packaging in accordance with the procedure established by the norms and rules in the field of consumption waste management. If possible, dispose of paper, plastic, metal waste in the containers designed for these materials.

## 9. WARRANTY

The current warranty terms and conditions are listed on the Manufacturer's website. In case of discrepancies, the terms and conditions listed on the Manufacturer's website shall take precedence.

The warranty period for the product is 1 year from the date of sale, but no more than 1.5 years from the date of manufacture.

The warranty period can be extended according to special programs from the Manufacturer. The date of sale is the date of issue of shipping documents and/or the date of completion of the warranty card.

This warranty entitles the Buyer to have the product repaired free of charge in the event of defects related to materials and assembly. Warranty, as well as non-warranty and post-warranty repairs shall be made only by the Manufacturer.

The warranty does not cover packaging materials.

Warranty repair of partially or completely disassembled equipment is excluded. Such repairs are available on a chargeable basis.

### **Warranty repairs are not available in the following cases:**

- ◆ when the equipment is not used for its intended purpose as specified in the operating instructions;
- ◆ in the event of external mechanical damage to the equipment;
- ◆ in case of defects due to non-compliance with storage and transportation rules, force majeure circumstances, as well as adverse atmospheric or other external effects on the equipment, such as
- ◆ rain, snow, high humidity, heating, aggressive environments, etc;
- ◆ when damage has occurred due to non-compliance with the operating conditions specified in the manual or when unauthorized modifications have been made;
- ◆ when foreign objects enter the equipment;
- ◆ in the event of defects and breakdowns due to untimely preventive maintenance, including cleaning and lubrication of the equipment in accordance with the instructions in the operating manual.

Adjustment, maintenance and preventive maintenance of equipment (for example: cleaning, washing, lubrication, replacement of technical fluids) is not a warranty service and is provided on a fee basis.

Failure to follow the operating instructions specified in the user manual will void the warranty. To send the product for warranty, non-warranty or post-warranty service, you must first send a claim to the manufacturer.

# CERTIFICATE OF ACCEPTANCE AND SALE

The TSPROF Pioneer sharpening device complies with the technical documentation and is approved for use.

**Serial number:**

---

QC date:

QC manager:

---

---

 / 

---

**To be filled in at the time of sale:**

Date:

Seller's signature:

---

---

Place for stamp

**TSPROF**